

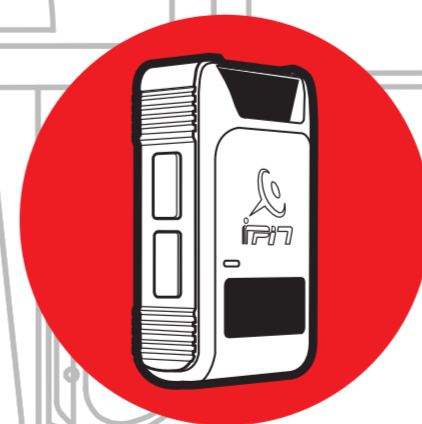

iPin Spatial Ruler Pro

The Handy Tool to Get Measuring Jobs Done Faster

Stand Alone Use

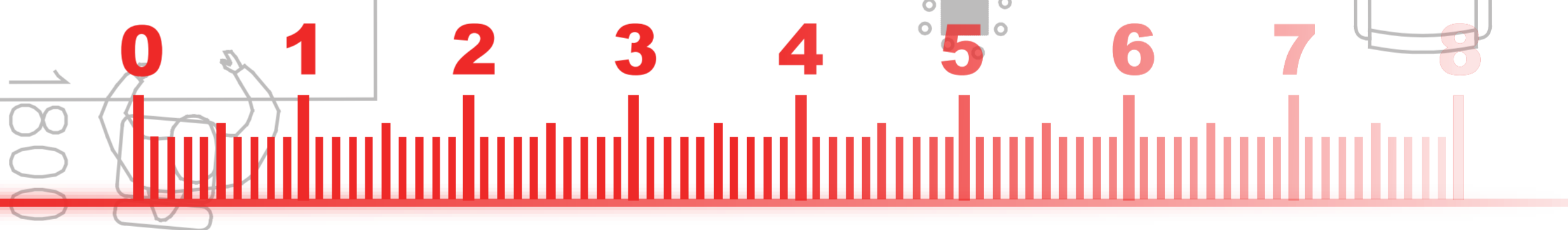

iPin Spatial Ruler Pro

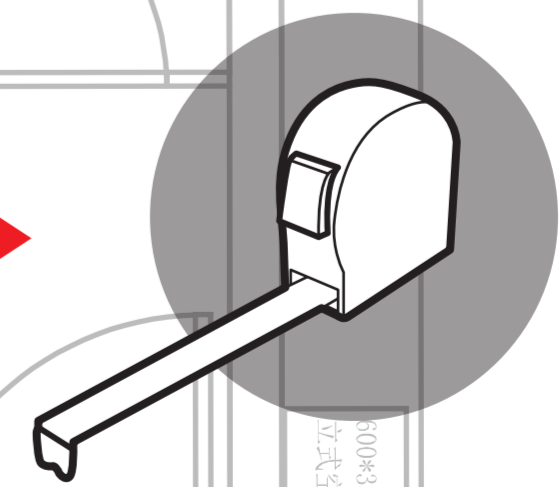

Tape Measure

1320

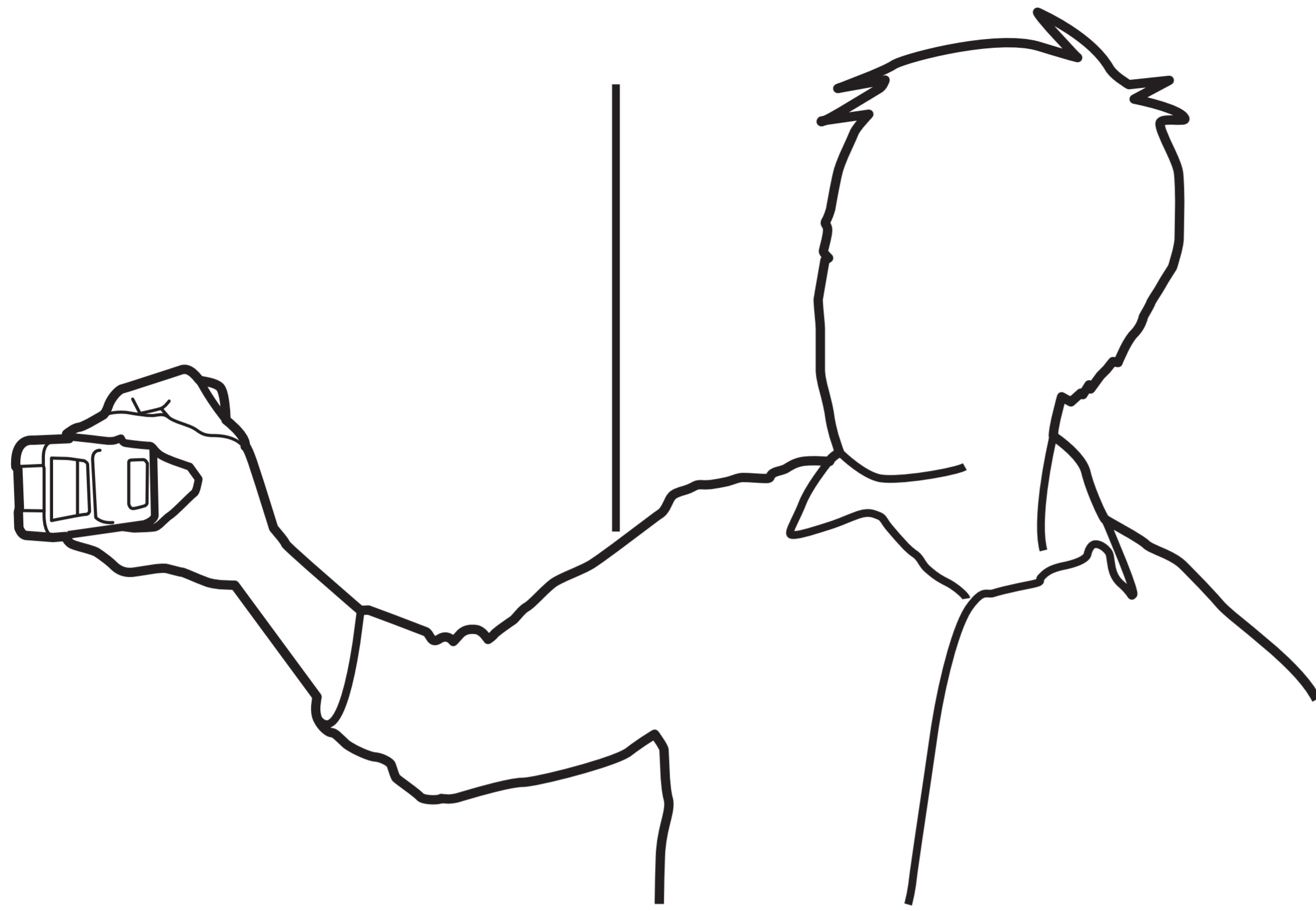

Portable and Ergonomic :

Allows for one-handed operation with a large contact surface for added stability during measurement.

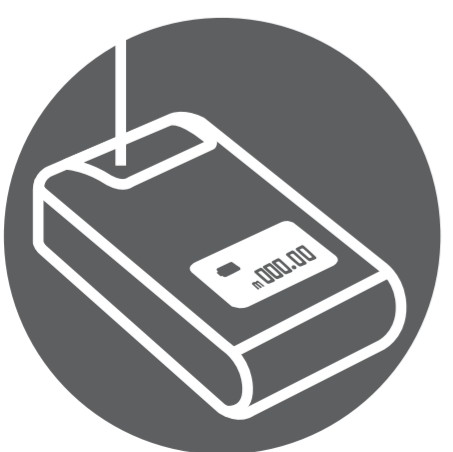

Optimized User Interface :

Unique Same-Surface design allows simultaneous laser output and data reading.

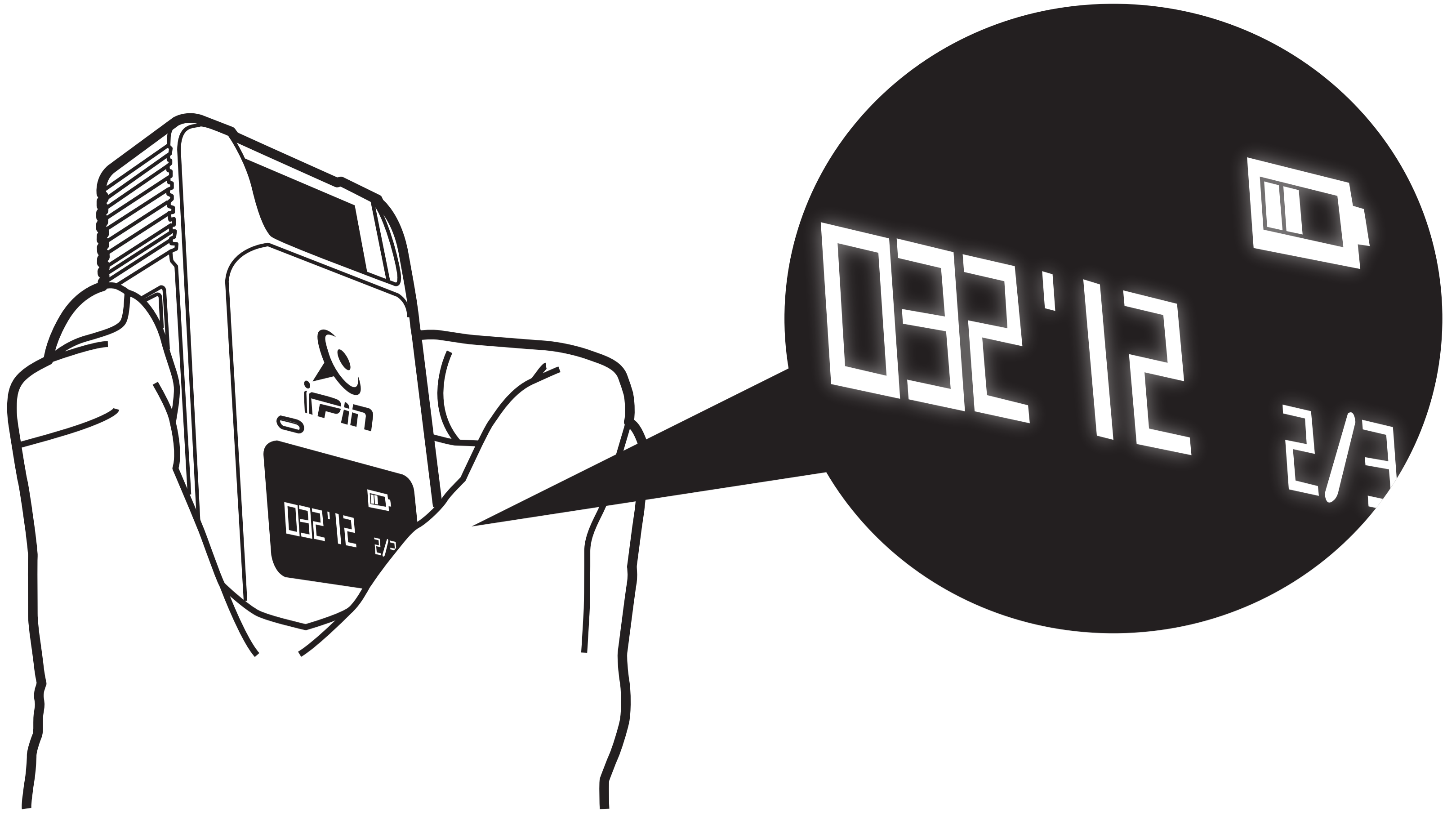

OLED Display :

Clear and sharp data display enhances visibility in bright or dim rooms.

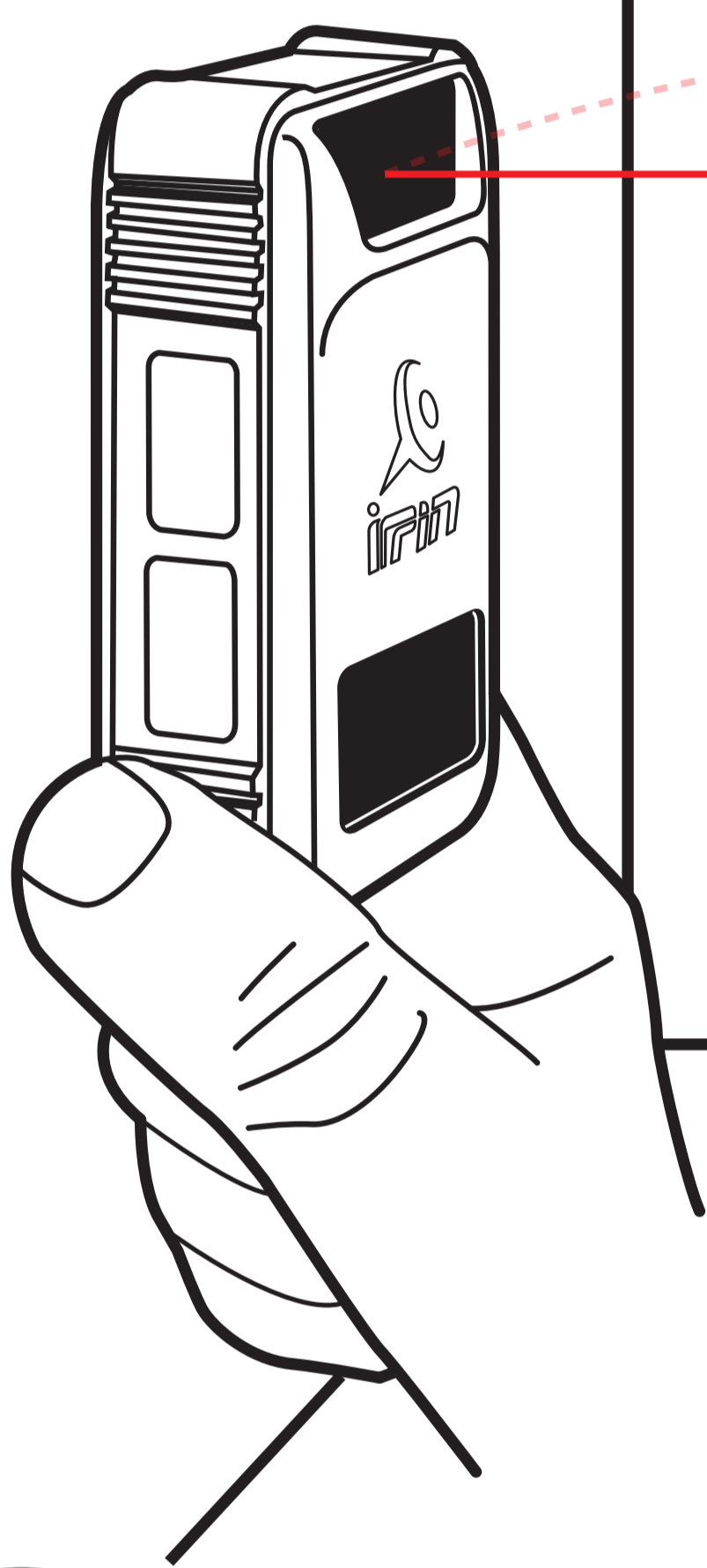

Working range 40m

Highly visible 635nm Laser

Deviation $\leq \pm 3\text{mm}$

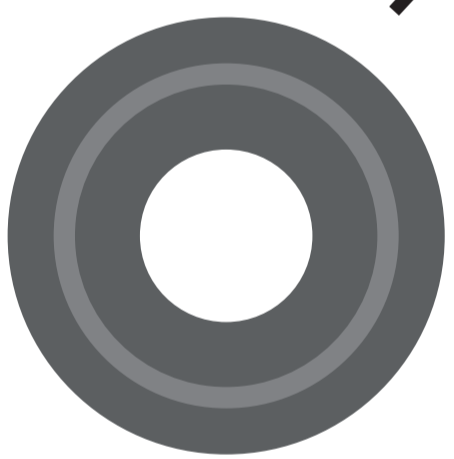

Highly Visible Red Laser :

Unique amber-red laser (635nm) increases visibility from afar.

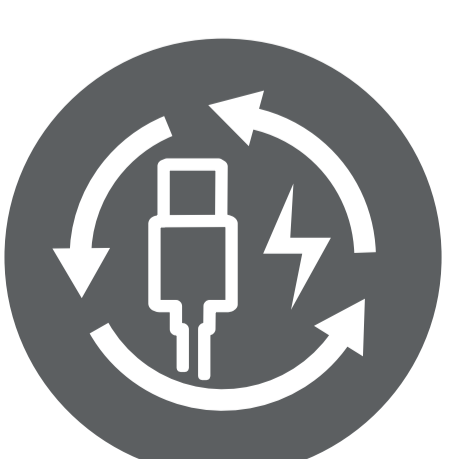
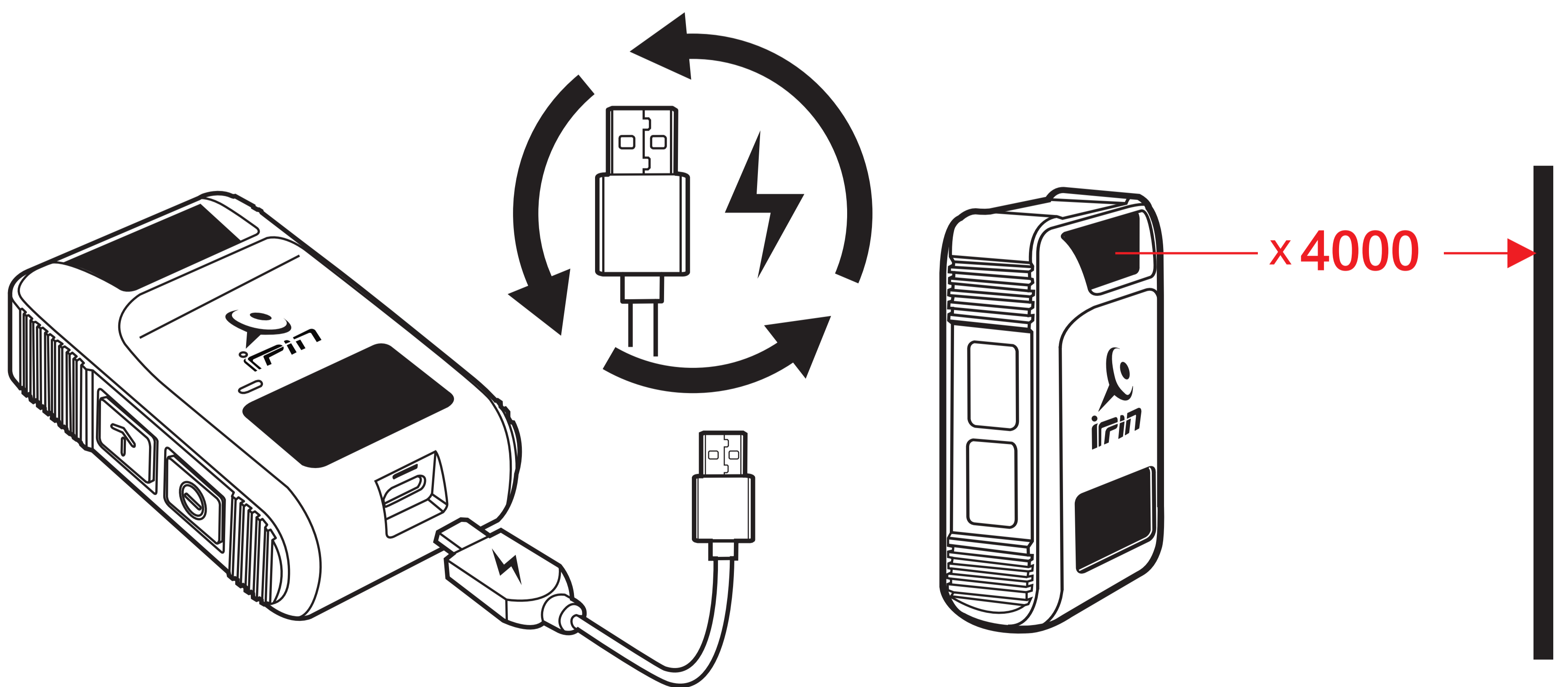

Long Life Lithium Battery :

Rechargeable using standard micro-USB for up to 4000 point-to-point measurements per full charge.

Pair with Phone + APP

Get extended functionalities by pairing your iPin Spatial Ruler Pro to your smartphone.

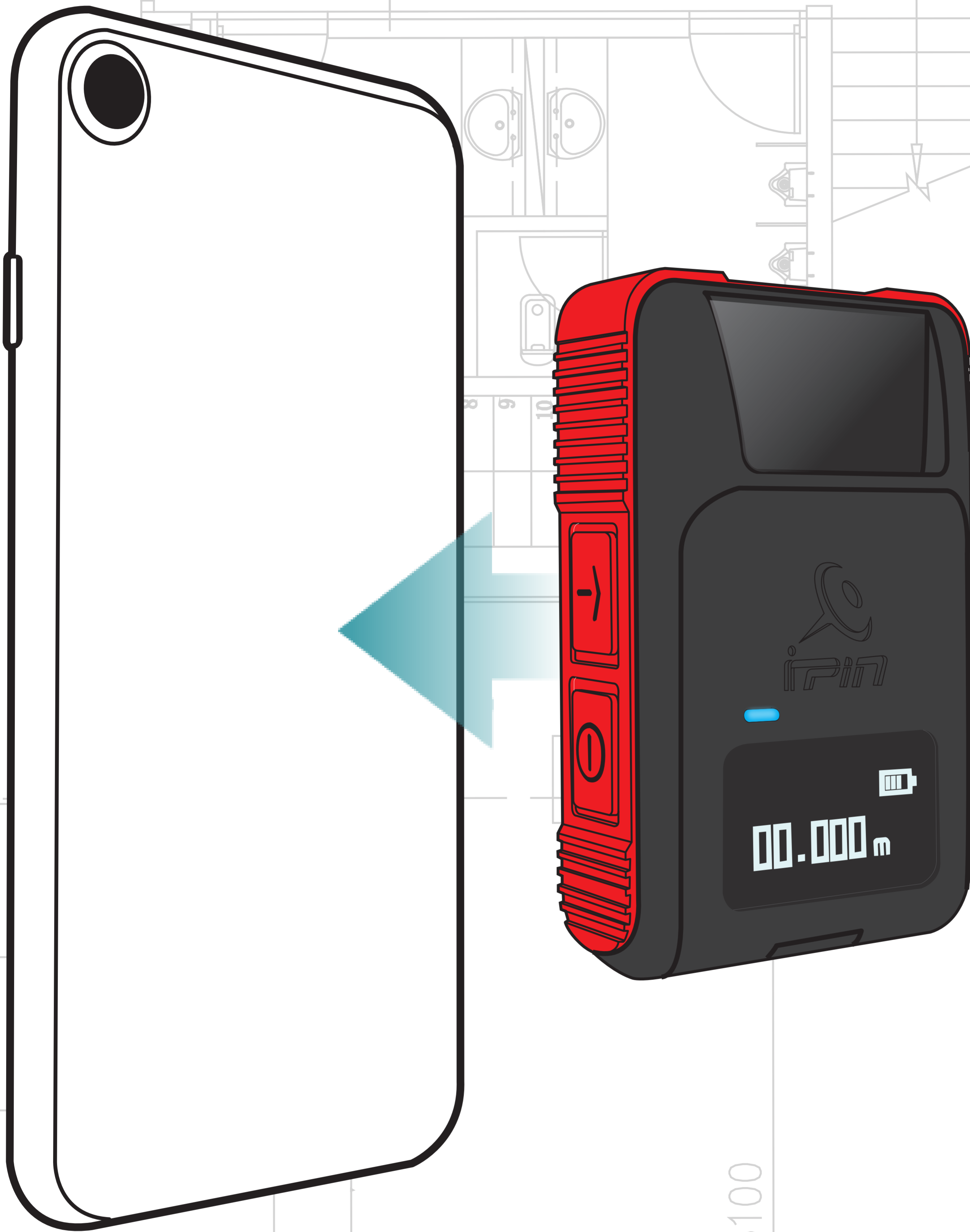

Explore 3-axis measurements



Save time by shooting first and measuring later



Reduce errors by sharing data-embedded photos with your team



Smartphone



iPin Spatial Ruler Pro



Time

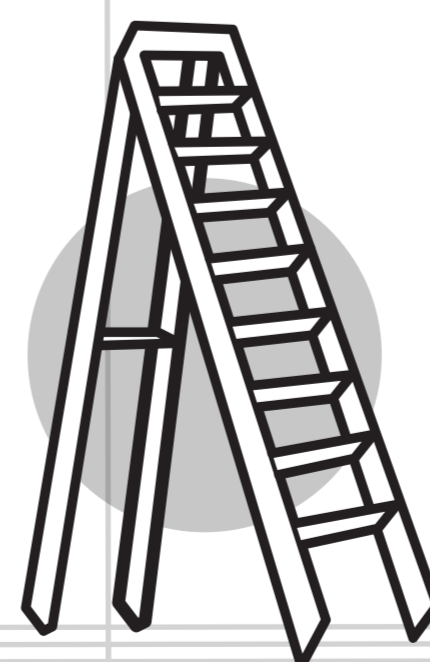

Ladder



Camera

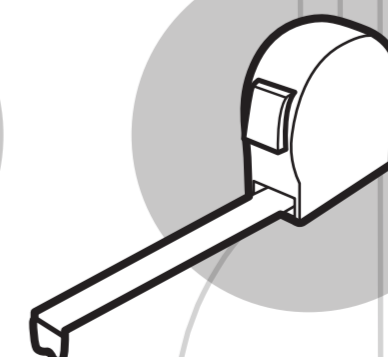

Tape Measure



Memo

6100

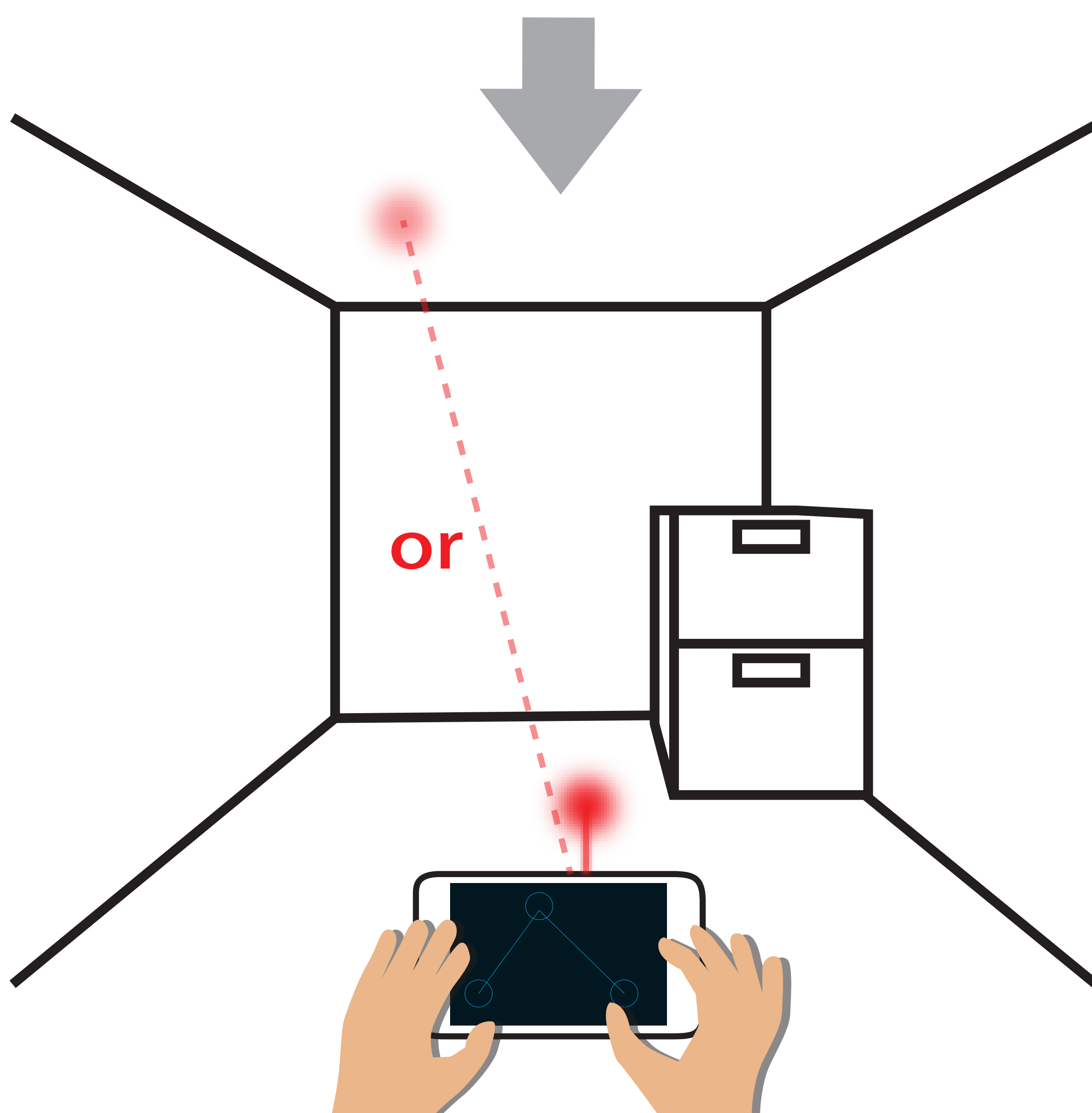

Anchor the laser on horizontal planes

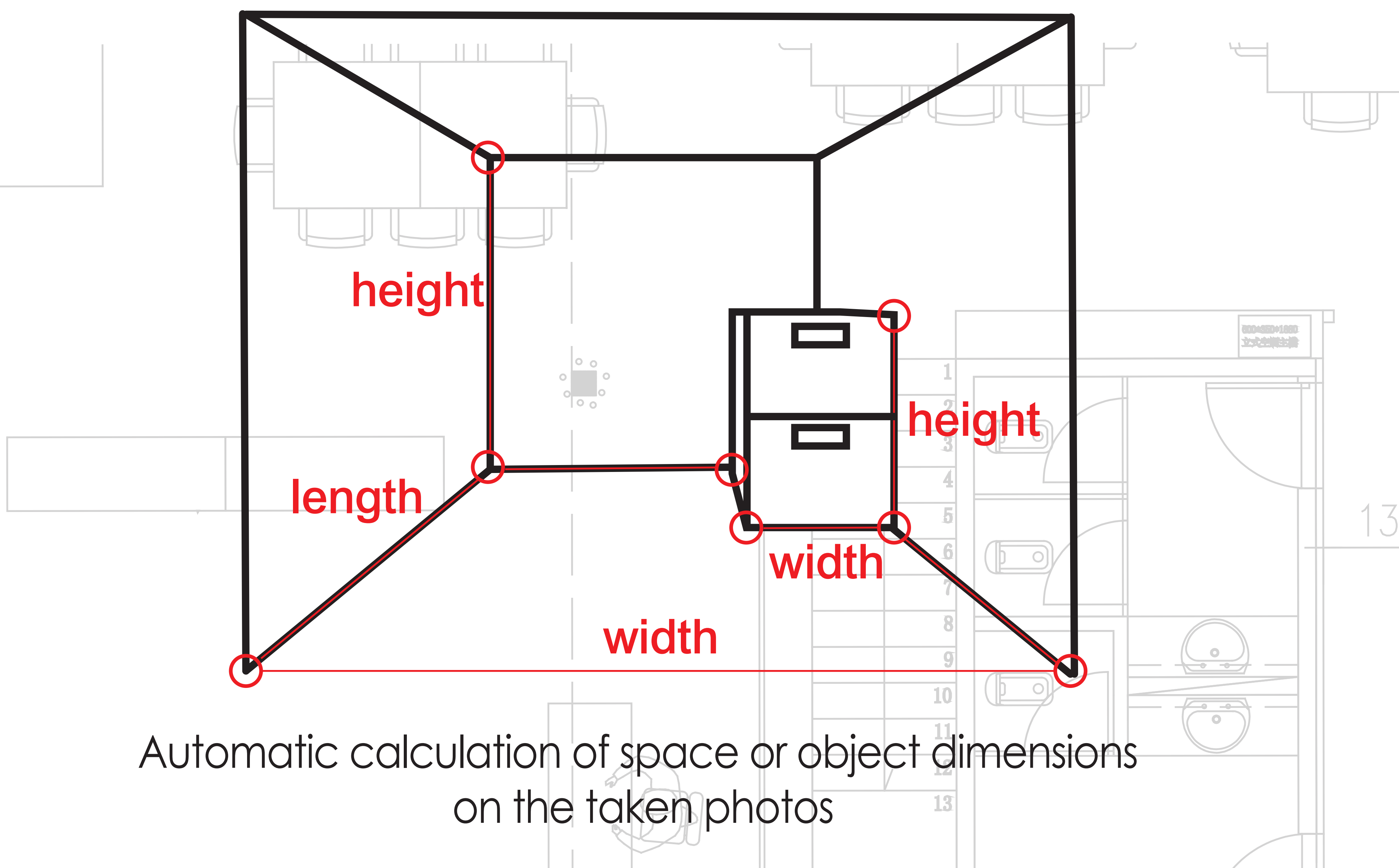
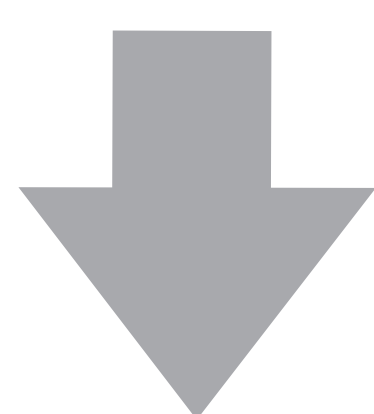

Automatic calculation of space or object dimensions on the taken photos

Usage Scenario 1

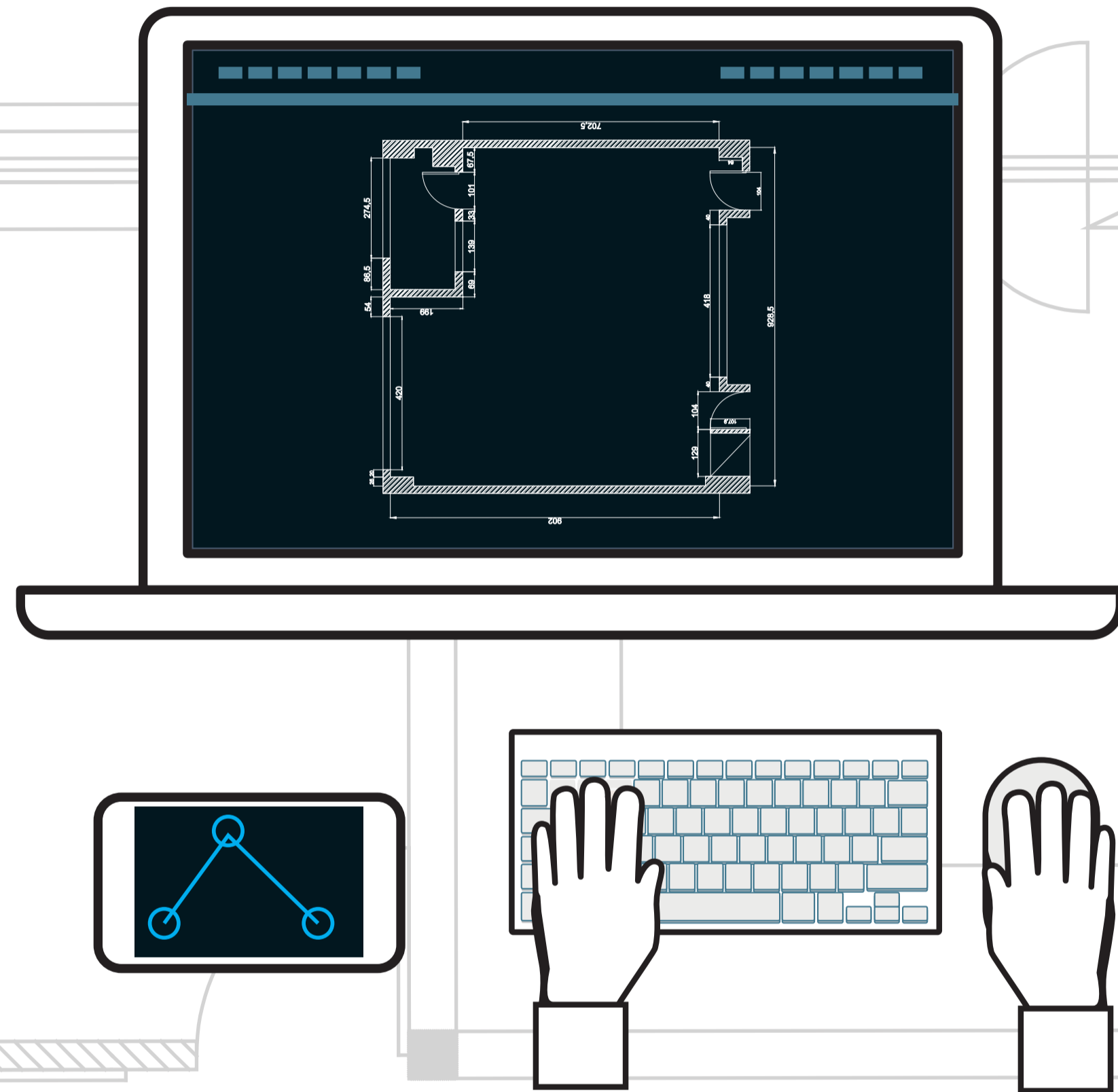

Use the photo with embedded measurement data to draw up or modify design files.

Usage Scenario 2

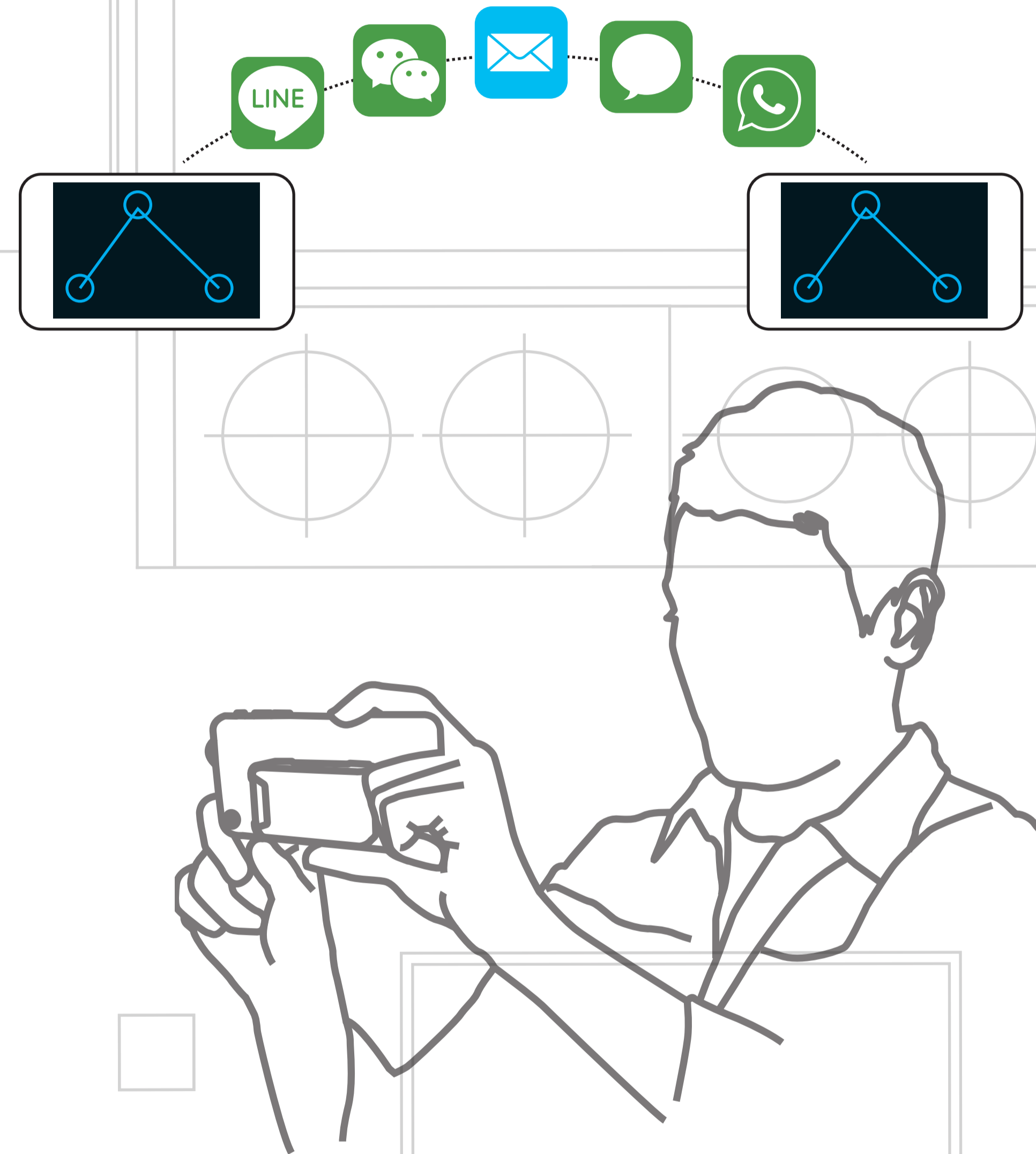

Share data-embedded photos for unlimited remeasuring using the App.